

☆☆☆ 206 Series ☆☆☆

P/N: W206V**G01

Material: PBT with Glass-Filled, UL 94V-0, Black

Conductor: SQ0.5*8.8mm, Brass, Tin-Plated

Available: 2~40P

Mate with H206

REVISIONS			
REV	DESCRIPTION	DATE	DRAWN
A			

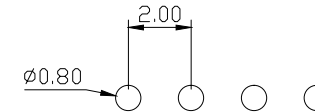

RECOMMENDED P.C.BOARD HOLE DIMM.

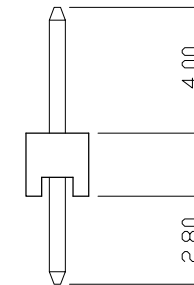
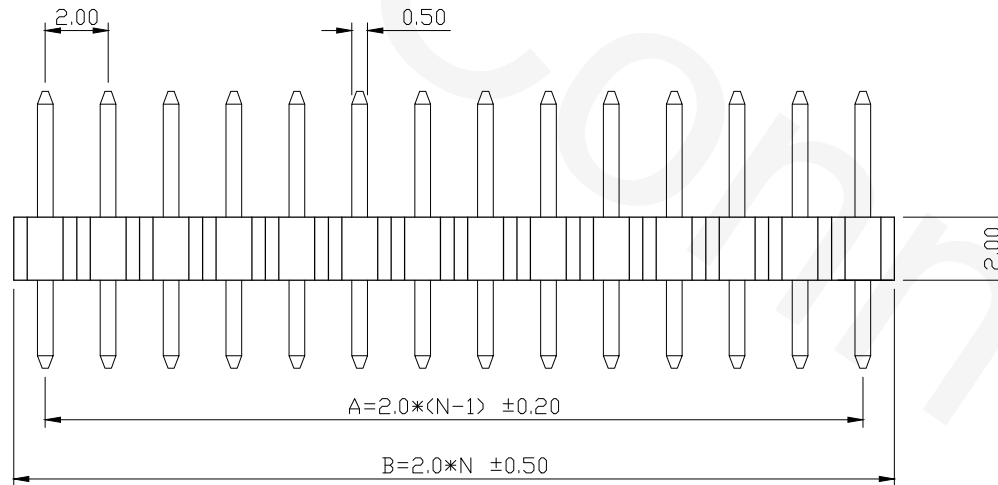

RoHS Compliant



TEL: 886-2-86871898 FAX: 886-2-86872959
 Mail: tceldh@gmail.com Web: http://www.cnj.tw/

TITLE
 .079"(2.0mm) Wire to Board Vertical Single Row Wafer

DIMENSION TOLERANCE	
.x	±0.30 x° ±2°
.xx	±0.20
.xxx	±0.10

P/N	W206V**G01	CHECKED	David	UNIT	mm	DATE	2010/08/30
DRAWN	Michael	APPROVED	Lily	SCALE	1:1	REV	A

☆☆☆ 206 Series ☆☆☆

P/N: W206V**G02

Material: PBT with Glass-Filled, UL 94V-0, Black

Conductor: SQ0.5*8.8mm, Brass, Gold-Flash

Available: 2~80P

Mate with H206

REVISIONS			
REV	DESCRIPTION	DATE	DRAWN
A			

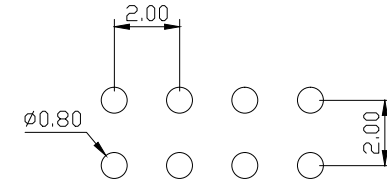
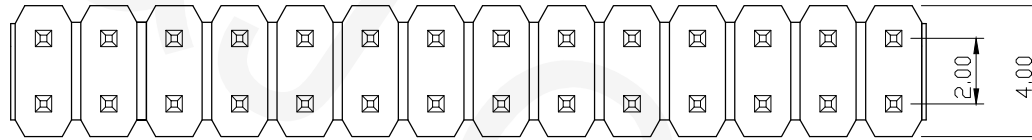

RECOMMENDED P.C.BOARD HOLE DIMM.

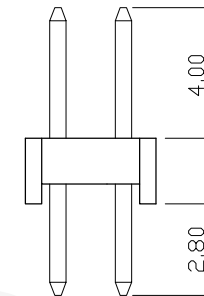
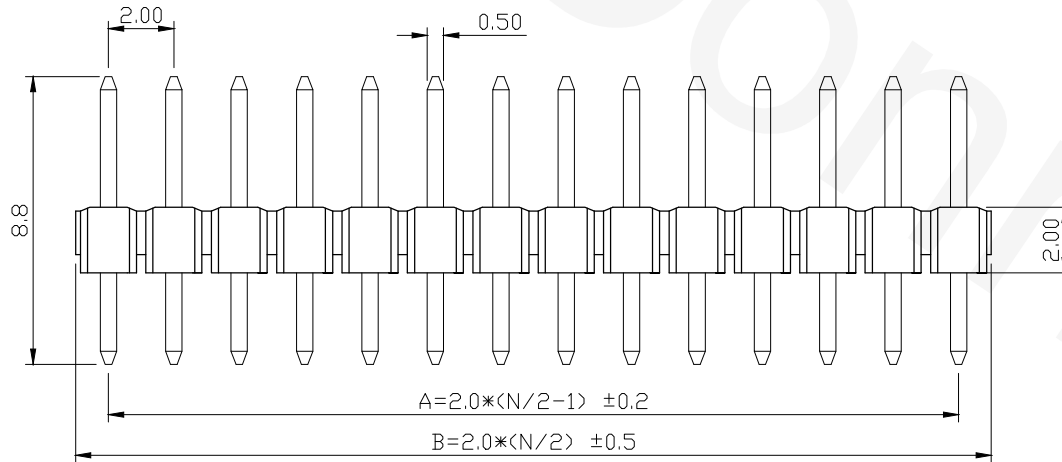

RoHS Compliant



TEL: 886-2-86871898 FAX: 886-2-86872959
 Mail: tceldh@gmail.com Web: http://www.cnj.tw/

TITLE
 .079"(2.0mm) Wire to Board Vertical Dual Row Wafer

DIMENSION TOLERANCE	
.x	±0.30 x° ±2°
.xx	±0.20
.xxx	±0.10

P/N	W206V**G02	CHECKED	David	UNIT	mm	DATE	2010/08/30
DRAWN	Michael	APPROVED	Lily	SCALE	1:1	REV	A

☆☆☆ 206 Series ☆☆☆

P/N: W206H**G01

Material: PBT with Glass-Filled, UL 94V-0, Black

Conductor: Brass, Gold-Flash

Available: 4~40P

Mate with H206

REVISIONS			
REV	DESCRIPTION	DATE	DRAWN
A			

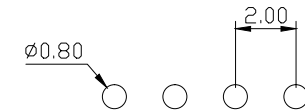
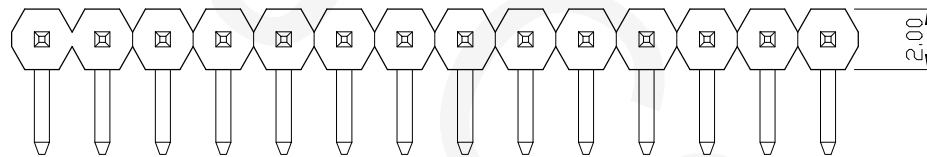

RECOMMENDED P.C. BOARD HOLE DIMM.

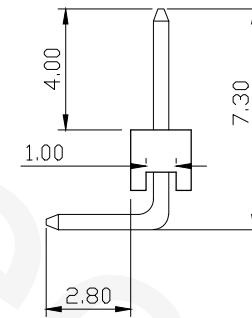
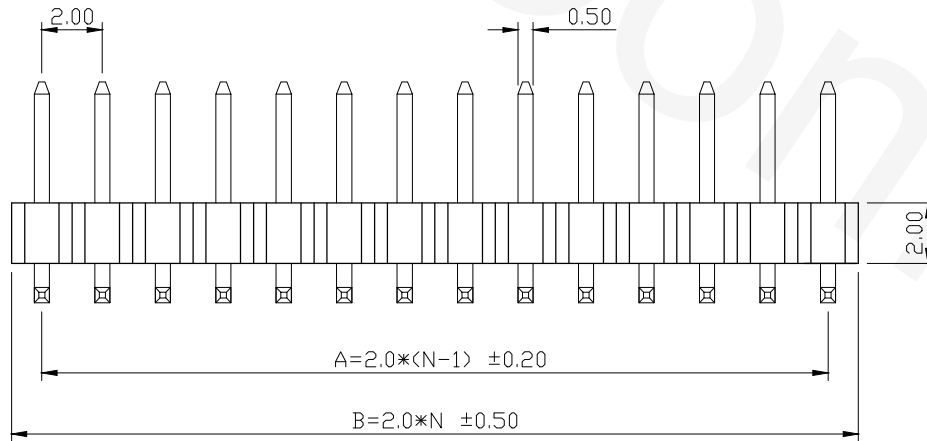

RoHS Compliant



TEL: 886-2-86871898 FAX: 886-2-86872959
 Mail: tceldh@gmail.com Web: <http://www.cnj.tw/>

TITLE
 .079"(2.0mm) Wire to Board Horizontal Single Row Wafer

DIMENSION TOLERANCE	
.x	± 0.30 x° $\pm 2^\circ$
.xx	± 0.20
.xxx	± 0.10

P/N	W206H**G01	CHECKED	David	UNIT	mm	DATE	2010/08/30
DRAWN	Michael	APPROVED	Lily	SCALE	1:1	REV	A

☆☆☆ 206 Series ☆☆☆

P/N: W206H**G02

Material: PBT with Glass-Filled, UL 94V-0, Black

Conductor: Brass, Gold-Flash

Available: 4~80P

Mate with H206

REVISIONS			
REV	DESCRIPTION	DATE	DRAWN
A			

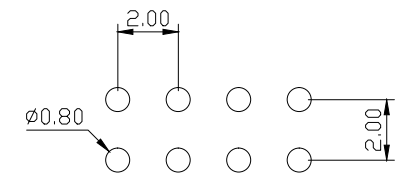
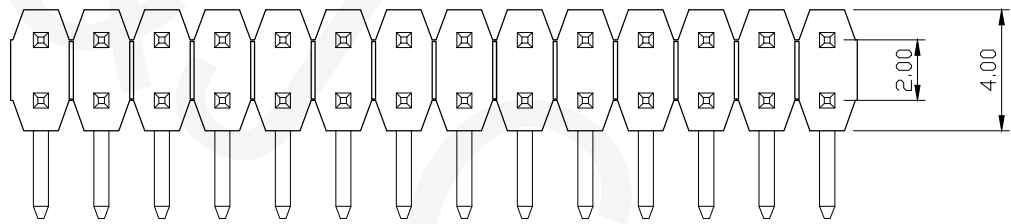

RECOMMENDED P.C. BOARD HOLE DIMM.

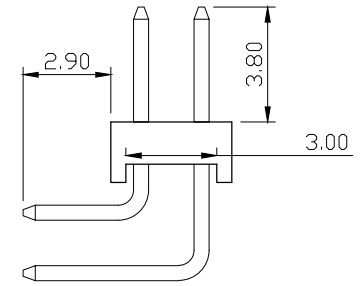
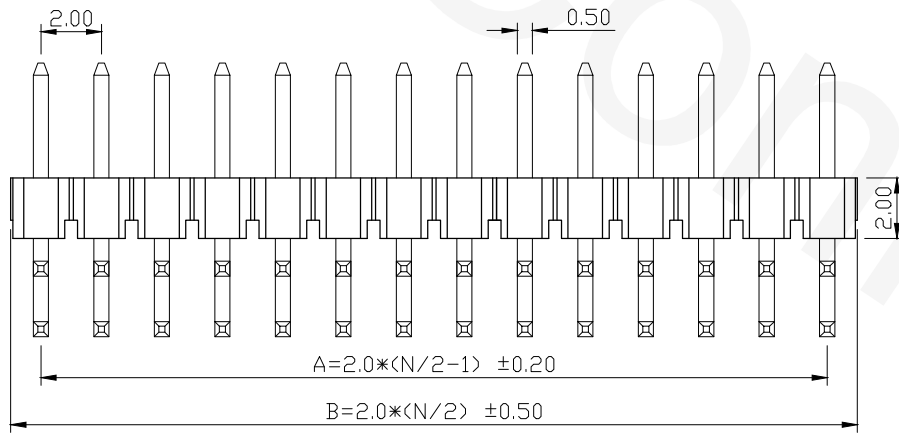

RoHS Compliant



TEL: 886-2-86871898 FAX: 886-2-86872959
 Mail: tceldh@gmail.com Web: http://www.cnj.tw/

TITLE
 .079"(2.0mm) Wire to Board Horizontal Dual Row Wafer

DIMENSION TOLERANCE	
.x	± 0.30 x° $\pm 2^\circ$
.xx	± 0.20
.xxx	± 0.10

P/N	W206H**G02	CHECKED	David	UNIT	mm	DATE	2010/08/30
DRAWN	Michael	APPROVED	Lily	SCALE	1:1	REV	A

☆☆☆ 206 Series ☆☆☆

P/N: H206S**000

Material: PBT, UL 94V-0, Black

Available: 2~40P

REVISIONS			
REV	DESCRIPTION	DATE	DRAWN
A			

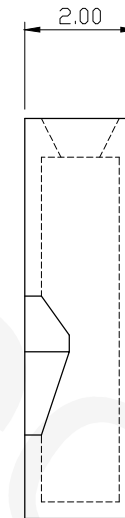
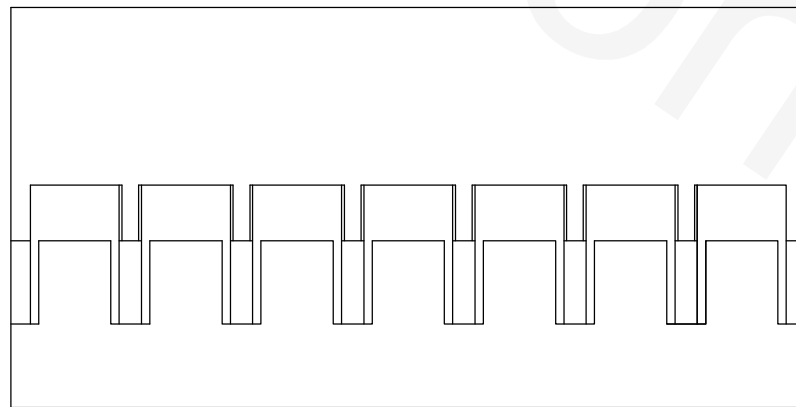
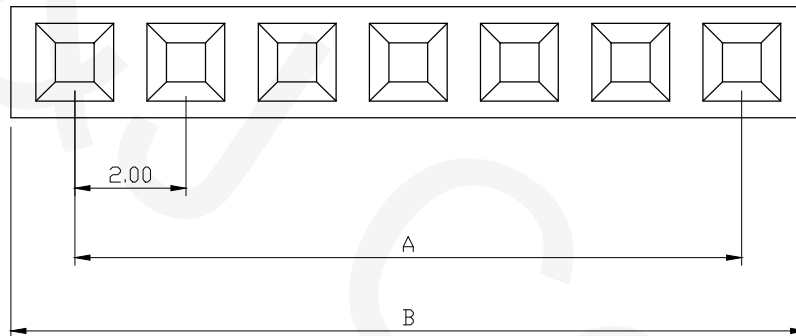

Circuitis	Dim. A	Dim. B
2	2.00	4.20
3	4.00	6.20
4	6.00	8.20
5	8.00	10.20
6	10.00	12.20
7	12.00	14.20
8	14.00	16.20
9	16.00	18.20
10	18.00	20.20
11	20.00	22.20
12	22.00	24.20
13	24.00	26.20
N	N*2-2	N*2+0.2
40	78.00	80.20

RoHS Compliant



TEL: 886-2-86871898 FAX: 886-2-86872959
 Mail: tceldh@gmail.com Web: http://www.cnj.tw/

TITLE

.079"(2.0mm) Wire to Board Housing

DIMENSION TOLERANCE

.x ±0.30 x° ±2°
 .xx ±0.20
 .xxx ±0.10

P/N	H206S**000	CHECKED	David	UNIT	mm	DATE	2010/08/03
DRAWN	Michael	APPROVED	Lily	SCALE	1:1	REV	A

A

B

C

D

E

F

☆☆☆ 206 Series ☆☆☆

P/N: T206P00G00

Conductor: Phosphor Bronze/ GOLD-FLASH

Thickness: 0.2mm

REVISIONS

REV	DESCRIPTION	DATE	DRAWN
A			

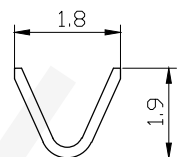

Section A-A

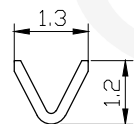

Section B-B

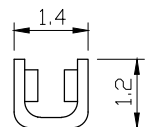

Section C-C

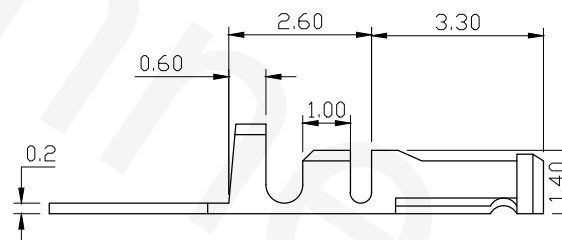
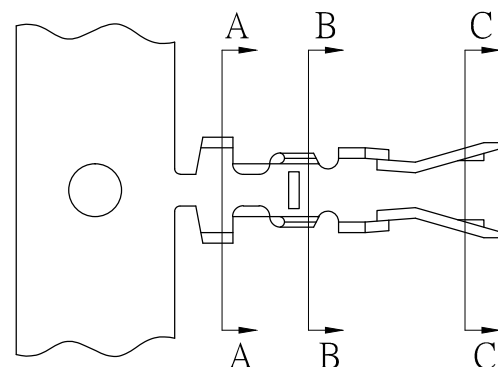

RoHS Compliant



C&J Connector

TEL: 886-2-86871898 FAX: 886-2-86872959
 Mail: tceldh@gmail.com Web: http://www.cnj.tw/

TITLE

.079"(2.0mm) Crimp Terminal

DIMENSION TOLERANCE

.x ±0.30 x° ±2°

.xx ±0.20

.xxx ±0.10

P/N	T206P00G00	CHECKED	David	UNIT	mm	DATE	2010/08/04
DRAWN	Michael	APPROVED	Lily	SCALE	1:1	REV	A

A

B

C

D

E

F